

PL2657



Flush pressure transmitter

PL-001BREA01-E-ZVG/US/ IP

discontinued article

Alternative article: PM1607 When selecting an alternative article and accessories please note that technical data may differ! –
When selecting an alternative article and accessories please note that technical data may differ! – Discontinuation date: 31.03.2019

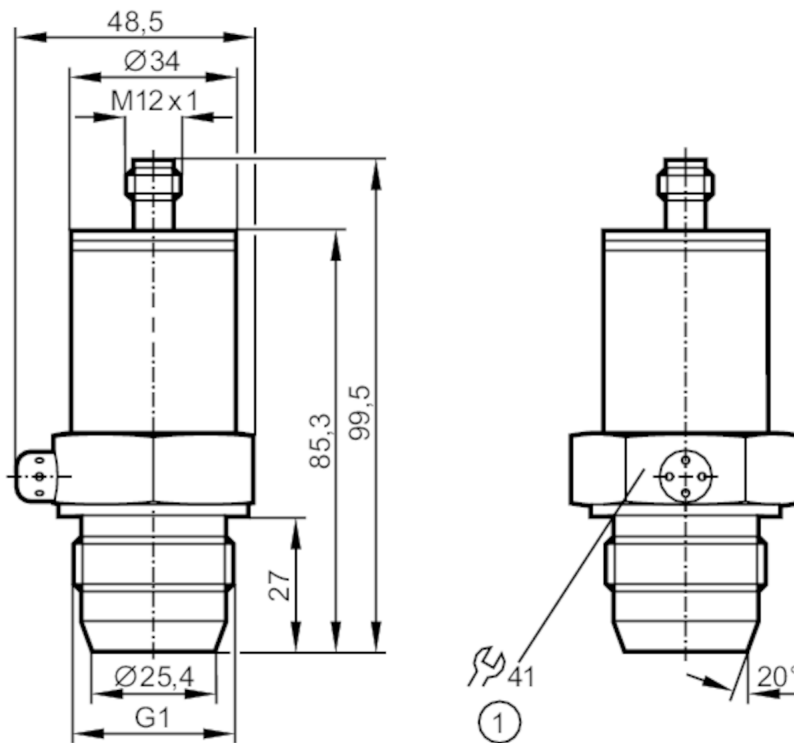

1 Tightening torque 20 Nm



Application	
Application	hygienic systems
Media	viscous media and liquids with suspended particles; liquids and gases
Medium temperature [°C]	-25...80
Pressure rating	10000 mbar 145 psi 1000 kPa
Min. bursting pressure	30000 mbar 450 psi 3000 kPa
Type of pressure	relative pressure
No dead space	yes
Electrical data	
Operating voltage [V]	14...30 DC
Min. insulation resistance [MΩ]	100; (500 V DC)
Protection class	III
Reverse polarity protection	yes
Inputs / outputs	
Number of inputs and outputs	Number of analogue outputs: 1



Flush pressure transmitter

PL-001BREA01-E-ZVG/US/ IP

Outputs			
Total number of outputs	1		
Output signal	analogue signal		
Number of analogue outputs	1		
Analogue current output [mA]	4...20		
Max. load [Ω]	550; ($U_b = 24\text{ V}$; ($U_b - 13\text{ V}$) / 20 mA)		
Overload protection	yes		
Measuring/setting range			
Measuring range	-50...1000 mbar	-0.7...14.5 psi	-5...100 kPa
Analogue start point	-50...749 mbar	-0.7...10.9 psi	-5...74.9 kPa
Analogue end point	200...999 mbar	2.9...14.5 psi	20...99.9 kPa
In steps of	1 mbar	0.1 psi	0.1 kPa
Factory setting		ASP = 0 mbar	AEP = 999 mbar
Accuracy / deviations			
Repeatability [% of the span]	< $\pm 0,1$; (with temperature fluctuations < 10 K; Turn down 1:1)		
Characteristics deviation [% of the span]	< $\pm 0,6$; (Turn down 1:1 linearity, incl. hysteresis and repeatability limit value setting to DIN 16086)		
Linearity deviation [% of the span]	< $\pm 0,5$; (Turn down 1:1)		
Hysteresis deviation [% of the span]	< $\pm 0,1$; (Turn down 1:1)		
Long-term stability [% of the span]	< $\pm 0,1$; (Turn down 1:1; per year)		
Temperature coefficient zero point [% of the span / 10 K]	< $\pm 0,1$; (0...80 °C)		
Temperature coefficient span [% of the span / 10 K]	< $\pm 0,2$; (0...80 °C)		
Response times			
Max. response time analogue output [ms]	3		
Software / programming			
Parameter setting options	zero point; span		
Interfaces			
Communication interface	EPS		
Operating conditions			
Ambient temperature [°C]	-25...80		
Storage temperature [°C]	-40...100		
Protection	IP 67		

PL2657



Flush pressure transmitter

PL-001BREA01-E-ZVG/US/ IP

Tests / approvals		
EMC	EN 61000-4-2 ESD	4 kV CD / 8 kV AD
	EN 61000-4-3 HF radiated	10 V/m
	EN 61000-4-4 Burst	2 kV
	EN 61000-4-6 HF conducted	10 V
Shock resistance	DIN IEC 68-2-27	50 g (11 ms)
Vibration resistance	DIN IEC 68-2-6	20 g (10...2000 Hz)
MTTF	[years]	248

Mechanical data		
Weight	[g]	404
Materials	stainless steel (1.4404 / 316L); PEI; FKM	
Materials (wetted parts)	ceramics (99.9 % Al ₂ O ₃); PTFE; stainless steel (1.4435 / 316L); surface characteristics: Ra < 0,4 / Rz 4	
Min. pressure cycles	100 million	
Process connection	threaded connection G 1 external thread sealing cone	

Remarks	
Remarks	The 3-A qualification is only valid if adapters with 3-A qualification are used for installation.
Pack quantity	1 pcs.

Electrical connection

Connector: 1 x M12; Contacts: gold-plated



Connection

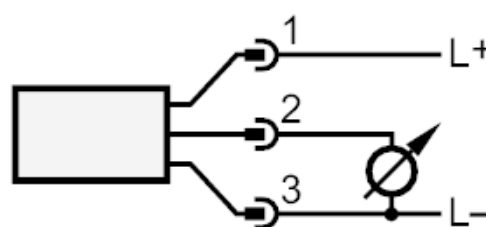
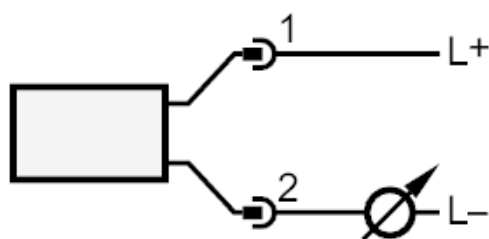

discontinued article

Alternative article: PM1607 When selecting an alternative article and accessories please note that technical data may differ! – When selecting an alternative article and accessories please note that technical data may differ! – Discontinuation date: 31.03.2019